

We have understood the auto engine water pump bearings decades, and led into ISO standard during the selecting materials and producing process.

Meantime, for the bearings is working in the high temperature and airtight environment for a long time, we are developing and using waterproof, high temperature resistance, antirust sealing and lubricating grease to make our bearings applicable to so abominable working conditions.

We make in a very large range auto engine water pump bearings to all over the world.

WAB	FAG	A	B	C	D
WB163073	W2289	2.89	0.16	1.20	0.6267
WB163083	W2325	3.25	0.16	1.56	0.6267
WB163090	W2355-3	3.55	0.67	1.35	0.6267
WB163093	W2366	3.66	0.73	1.40	0.6267
WB163094	W2371	3.71	0.69	1.50	0.6267
WB163096	W2375-3	3.76	0.56	1.67	0.6267
WB163098	W2385	3.86	0.67	1.66	0.6267
WB1630102	W2401-3	4.02	0.67	1.82	0.6267
WB1630103	W2406-1	4.06	0.92	1.61	0.6267
WB1630105	W2415-1	4.15	0.80	1.82	0.6267
WB1630106	W2417-2	4.17	0.81	1.83	0.6267
WB1630109	W2431	4.31	0.58	2.20	0.6267
WB1630110	W2434	4.35	0.84	1.97	0.6267
WB1630110A	W2434-1	4.35	0.84	1.97	0.6267
WB1630111	W2435	4.36	0.77	2.06	0.6267
WB1630112	W2439	4.39	0.94	1.92	0.6267
WB1630112A	W2440-4	4.40	1.15	1.72	0.6267
WB1630112B	W2441-1	4.41	1.06	1.82	0.6267
WB1630114A	W2446	4.47	1.08	1.86	0.6267
WB16301WB16	W2454	4.55	0.81	2.21	0.6267
WB16301WB16A	W2456	4.56	1.10	1.93	0.6267
WB16301WB16B	W2456-1	4.57	1.07	1.97	0.6267
WB1630119	W2468	4.69	1.47	1.69	0.6267
WB1630119A	W2468-1	4.69	1.47	1.69	0.6267
WB1630120	W2472	4.72	1.44	1.75	0.6267

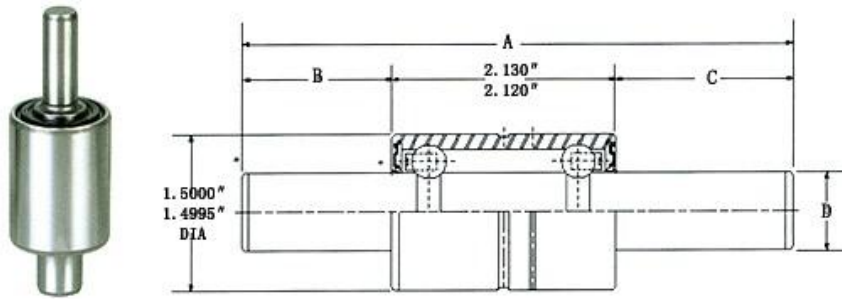

WAB	FAG	A	B	C	D
WB1938117	WK2461	4.62	0.53	1.96	0.7465
WB1938120	WK2474-2	4.74	1.02	1.60	0.7465
WB1938123	WK2484-1	4.85	1.22	1.50	0.7465
WB1938125	WK2493	4.93	1.00	1.80	0.7465
WB1938125-1	WK2494-1	4.94	1.04	1.78	0.7465
WB1938125-2	WK2495	4.95	1.21	1.61	0.7465
WB1938127	WK2500-2	5.00	1.23	1.64	0.7465
WB1938127-1	WK2500A	5.00	1.05	1.83	0.7465
WB1938127-2	WK2501	5.01	1.15	1.74	0.7465
WB1938127-3	WK2501-3	5.02	1.22	1.67	0.7465
WB1938128	WK2520	5.20	1.17	1.90	0.7465
WB1938132	WK2528-2	5.28	1.19	1.96	0.7465
WB1938135	WK2531	5.31	1.47	1.71	0.7465
WB1938135-1	WK2531-2	5.31	1.47	1.72	0.7465
WB1938135-2	WK2534	5.34	1.25	1.96	0.7465
WB1938136	WK2537-1	5.37	1.43	1.92	0.7465
WB1938136-1	WK2538-2	5.38	1.59	1.67	0.7465
WB1938139	WK2550	5.50	1.40	1.97	0.7465
WB1938140	WK2553	5.53	1.29	2.11	0.7465
WB1938141	WK2559-2	5.59	1.25	2.21	0.7465
WB1938141-1	WK2560	5.61	1.55	1.93	0.7465
WB1938143	WK2564-6	5.65	1.21	2.31	0.7465
WB1938146	WK2575	5.75	1.75	1.88	0.7465
WB1938146-1	WK2575-1	5.75	1.43	2.19	0.7465
WB1938146-4	WK2575-4	5.75	1.43	2.19	0.7465

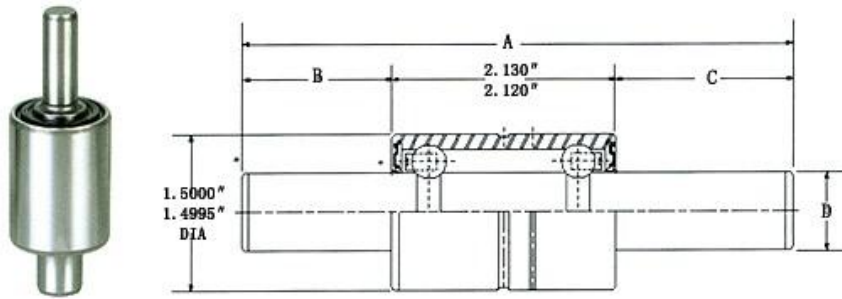

WAB	FAG	A	B	C	D
WR1630075	WN2269	2.96	0.99	0.18	0.6267
WR1630093	WN2366-4	3.66	0.73	1.40	0.6267
WR1630095	WN2375-3	3.76	0.56	1.67	0.6267
WR1630102	WN2401-5	4.02	0.67	1.82	0.6267
WR1630104	WN2410	4.10	1.03	1.54	0.6267
WR1630105	WN2415-1	4.15	0.80	1.82	0.6267
WR1630110	WN2434	4.35	0.84	1.97	0.6267
WR1630113	WN2447	4.48	1.42	1.52	0.6267
WR1630114	WN2448-1	4.49	0.75	2.21	0.6267
WR1630114-1	WN2450-2	4.50	1.26	1.71	0.6267
WR1630115	WN2454	4.55	0.81	2.21	0.6267
WR1630116	WN2456-1	4.56	1.10	1.93	0.6267
WR1630117	WN2462-1	4.62	1.34	1.75	0.6267
WR1630119	WN2468-2	4.69	0.71	2.44	0.6267
WR1630120	WN2475	4.75	1.10	2.12	0.6267
WR1630120-1	WN2476	4.76	1.16	2.07	0.6267
WR1630126	WN2497	4.97	1.45	1.99	0.6267
WR1630138	WN2547	5.47	0.91	3.03	0.6267
WR1630139	WN2548	5.49	1.38	2.58	0.6267
WR1630139-1	WN2548-1	5.49	1.63	2.33	0.6267
WR1630101	WN3399	4.00	0.69	1.78	0.6275
WR1630132	WN3520-2	5.20	1.58	2.09	0.6275
WR1630154	WN3607	6.07	1.17	3.37	0.6275
WR1630154-1	WN3607-1	6.07	1.17	3.37	0.6275
WR1630105	WN6415-1	4.15	0.80	1.82	0.6290

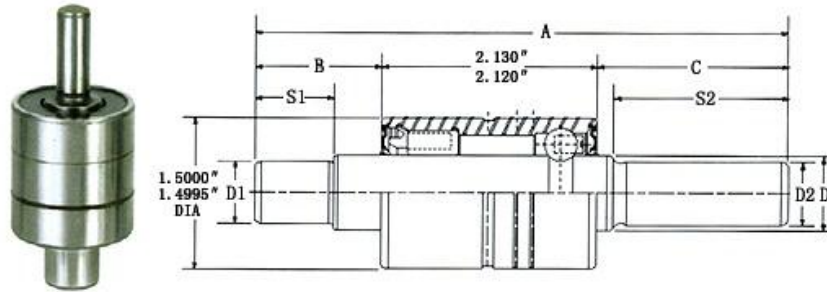

WAB	FAG	A	B	C	D
WR1938150	WKN2592-2	5.93	1.38	2.42	0.7465
WR1938151	WKN2596-1	5.96	1.22	2.61	0.7465
WR1938153	WKN2602-2	6.02	1.82	2.07	0.7465
WR1938153-1	WKN2604	6.04	1.80	2.11	0.7465
WR1938156	WKN2616	6.16	1.56	2.48	0.7465
WR1938158	WKN2622	6.22	1.84	2.25	0.7465
WR1938158-1D	WKN2622-1D	6.22	1.84	2.26	0.7465
WR1938158-2	WKN2623	6.23	1.70	2.40	0.7465
WR1938159	WKN2624	6.25	1.38	2.74	0.7465
WR1938160	WKN2631	6.32	1.75	2.44	0.7465
WR1938161	WKN2634-1	6.34	1.84	2.37	0.7465
WR1938174	WKN2688	6.88	2.11	2.65	0.7465
WR1938174-1	WKN2688-1	6.88	1.38	3.38	0.7465
WR1938174-3D	WKN2688-3D	6.88	1.38	3.38	0.7465
WR1938174-7D	WKN2688-7D	6.88	2.07	2.69	0.7465
WR1938115D	WKN6454D	4.54	0.92	1.49	0.7485
WR1938120-2	WKN6474-2	4.74	1.02	1.60	0.7485
WR1938136	WKN6534	5.34	1.26	1.96	0.7485
WR1938142-2B	WKN6560-2B	5.61	1.32	2.16	0.7485
WR1938146-1B	WKN6575-1B	5.75	1.43	2.19	0.7485
WR1938150-2B	WKN6592-2B	5.93	1.38	2.42	0.7485
WR1938151B	WKN6596B	5.96	1.21	2.62	0.7485
WR1938158B	WKN6623B	6.23	1.70	2.40	0.7485
WR1938161-1	WKN6634-1	6.34	1.84	2.37	0.7485